



This is an artistic rendering, not a technical drawing. Dimensions are estimates and are not guaranteed. May not be to exact scale.
 Ceiling Height: 10'6"

3/32" = 1'-0"
 L = 12"

20 Grove Street / First Floor

Listing no. 20170411S2

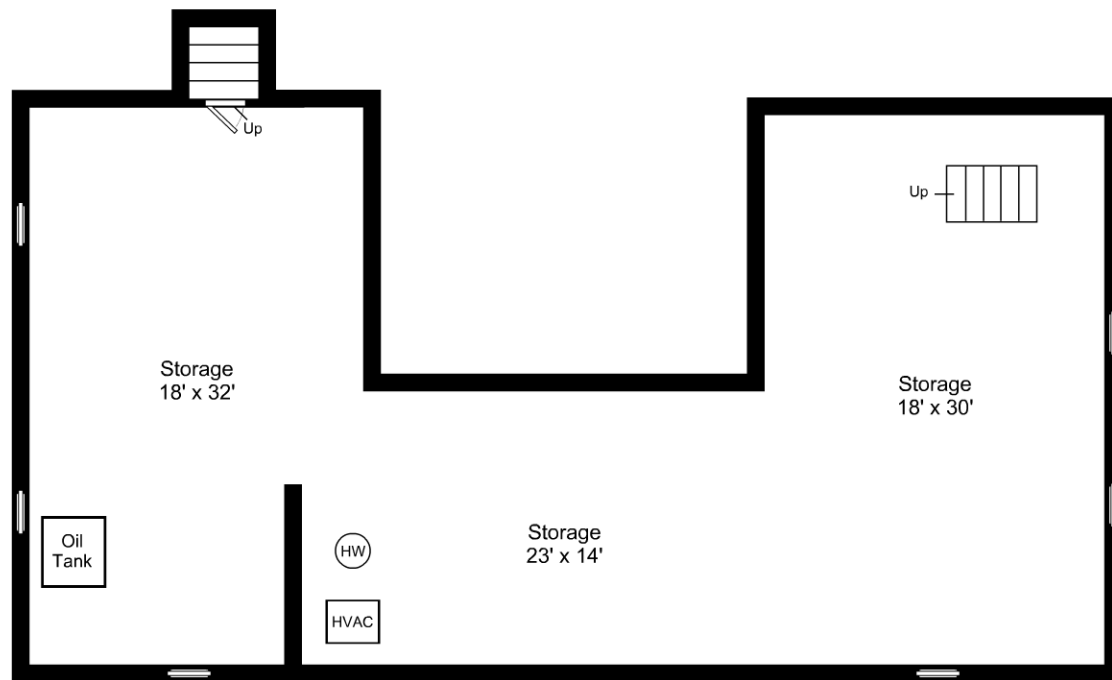

This is an artistic rendering, not a technical drawing. Dimensions are estimates and are not guaranteed. May not be to exact scale.

3/32" = 1'-0"

└ = 12"

20 Grove Street / Lower Level

Listing no. 20170411S2