



Artistic rendering for visual purposes only. Dimensions are estimates and are not guaranteed.

3/32" = 1'-0"
 — = 12"

1061 High Street / First Floor

Listing no. 20150225S1



Artistic rendering for visual purposes only. Dimensions are estimates and are not guaranteed.

3/32" = 1'-0"
 — = 12"

1061 High Street / Second Floor

Listing no. 20150225S1

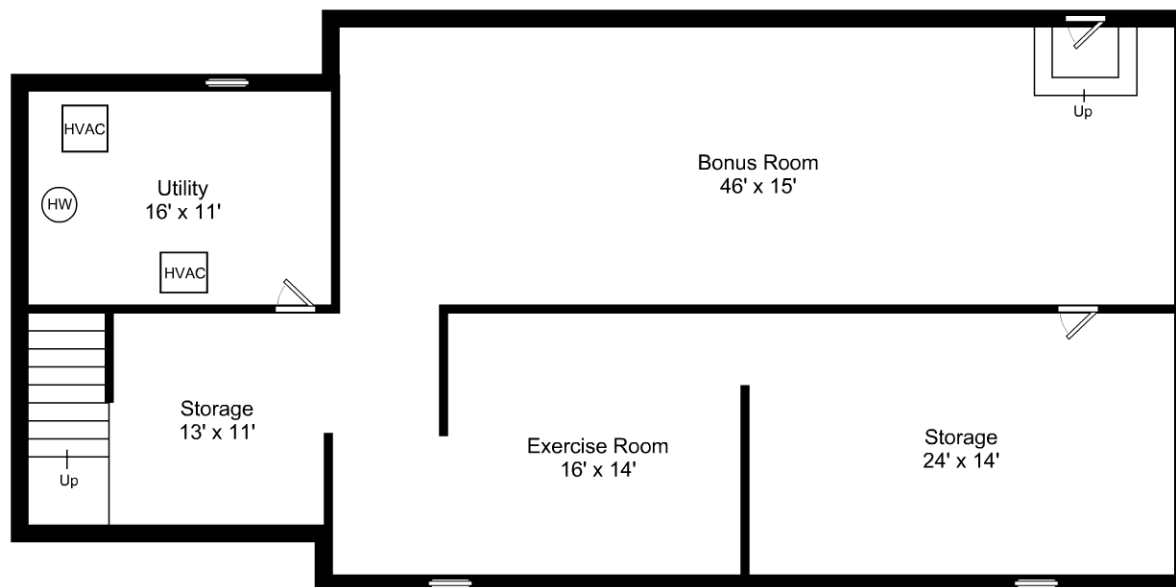

Artistic rendering for visual purposes only. Dimensions are estimates and are not guaranteed.

3/32" = 1'-0"

└ = 12"

1061 High Street / Lower Level

Listing no. 20150225S1