

Artistic Rendering for visual purposes only. Dimensions are estimates and are not guaranteed. May not be to exact scale.

1/8" = 1'-0"
 — = 12"

45 Old Rutherford Avenue / First Floor

Listing no. 20180918S1

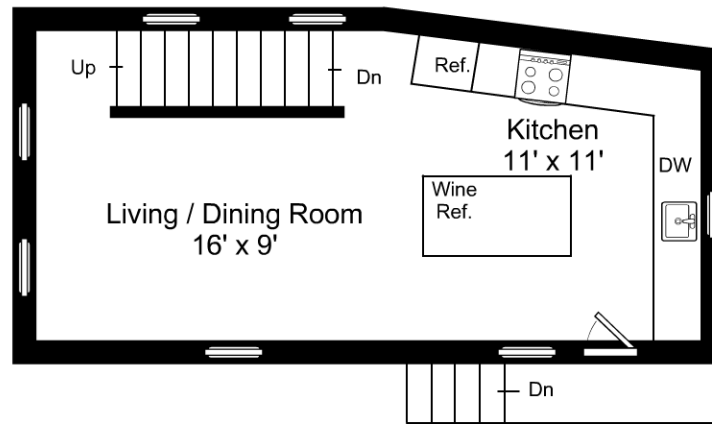

Artistic Rendering for visual purposes only. Dimensions are estimates and are not guaranteed. May not be to exact scale.

1/8" = 1'-0"
 — = 12"

45 Old Rutherford Avenue / Second Floor

Listing no. 20180918S1

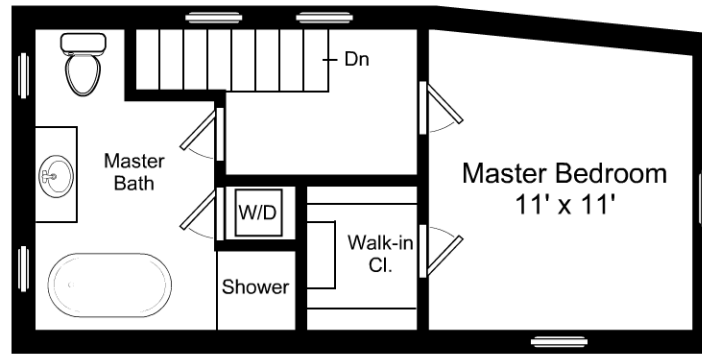

Artistic Rendering for visual purposes only. Dimensions are estimates and are not guaranteed. May not be to exact scale.

1/8" = 1'-0"
└─ = 12"

45 Old Rutherford Avenue / Third Floor

Listing no. 20180918S1